

## TO-126 Plastic-Encapsulate Transistors

### Features:

- power switching applications

### MAXIMUM RATINGS (T<sub>a</sub>=25°C unless otherwise noted)

Symbol	Parameter	Value	Unit
V <sub>CB0</sub>	Collector-Base Voltage	700	V
V <sub>CEO</sub>	Collector-Emitter Voltage	400	V
V <sub>EB0</sub>	Emitter-Base Voltage	9	V
I <sub>C</sub>	Collector Current -Continuous	1.5	A
P <sub>C</sub>	Collector Power Dissipation	1.5	W
T <sub>J</sub>	Junction Temperature	150	°C
T <sub>stg</sub>	Storage Temperature	-55~150	°C

### TO-126

- 1.BASE
- 2.COLLECTOR
- 3.EMITTER

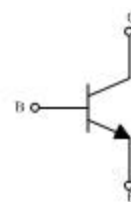
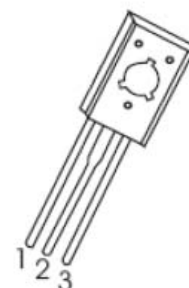

### ELECTRICAL CHARACTERISTICS (T<sub>a</sub>=25°C unless otherwise specified)

Parameter	symbol	Test conditions	Min	Typ	Max	Unit
Collector-base breakdown voltage	V <sub>(BR)CBO</sub>	I <sub>C</sub> =5mA, I <sub>E</sub> =0	700			V
Collector-emitter breakdown voltage	V <sub>(BR)CEO</sub>	I <sub>C</sub> =10mA, I <sub>B</sub> =0	400			V
Emitter-base breakdown voltage	V <sub>(BR)EBO</sub>	I <sub>E</sub> =2mA, I <sub>C</sub> =0	9			V
Collector cut-off current	I <sub>CBO</sub>	V <sub>CB</sub> =700V, I <sub>E</sub> =0			1	mA
Collector cut-off current	I <sub>CEO</sub>	V <sub>CE</sub> =400V, I <sub>B</sub> =0			0.5	mA
Emitter cut-off current	I <sub>EBO</sub>	V <sub>EB</sub> =9V, I <sub>C</sub> =0			1	mA
DC current gain	h <sub>FE1</sub>	V <sub>CE</sub> =5V, I <sub>C</sub> = 0.5 A	8		40	
	h <sub>FE2</sub>	V <sub>CE</sub> =5V, I <sub>C</sub> = 1.5A	5			
Collector-emitter saturation voltage	V <sub>CE(sat)</sub>	I <sub>C</sub> =1A, I <sub>B</sub> =0.25A			0.6	V
Base-emitter saturation voltage	V <sub>BE(sat)</sub>	I <sub>C</sub> =1A, I <sub>B</sub> =0.25A			1.2	V
Transition frequency	f <sub>T</sub>	V <sub>CE</sub> =10V, I <sub>C</sub> =100mA, f =1MHz	5			MHz
Fall time	t <sub>f</sub>	I <sub>C</sub> =1A, I <sub>B1</sub> =-I <sub>B2</sub> =0.2A, V <sub>CC</sub> =100V			0.5	μs
Storage time	t <sub>s</sub>	I <sub>C</sub> =250mA (UI9600)	2		4	μs

### THERMAL DATA

PARAMETER	SYMBOL	RATING	UNIT
Junction to Ambient	θ <sub>JA</sub>	100	°C/W
Junction to Case	θ <sub>JC</sub>	7.5	

### CLASSIFICATION OF h<sub>FE(1)</sub>

Range	10-15	15-20	20-25	25-30	30-35	35-40
-------	-------	-------	-------	-------	-------	-------

### CLASSIFICATION OF t<sub>s</sub>

Rank	A1	A2	B1	B2
Range	2-2.5 (μs)	2.5-3 (μs)	3-3.5 (μs)	3.5-4 (μs)

Typical Characteristics

# Typical Characteristics

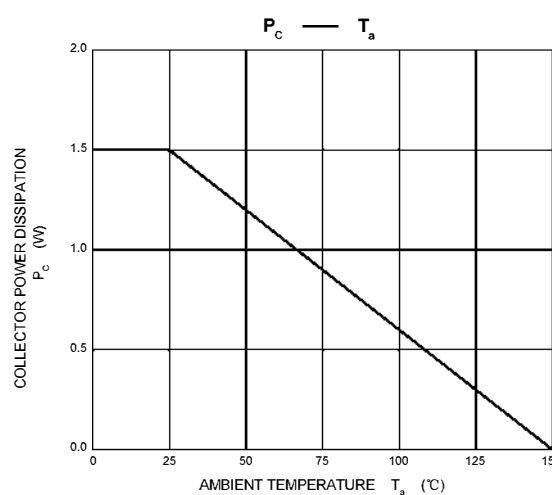
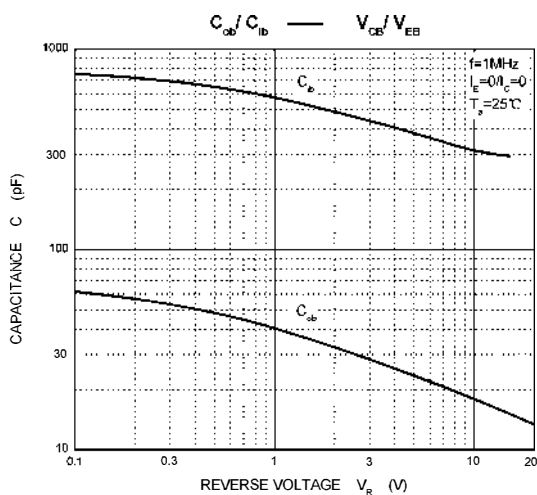
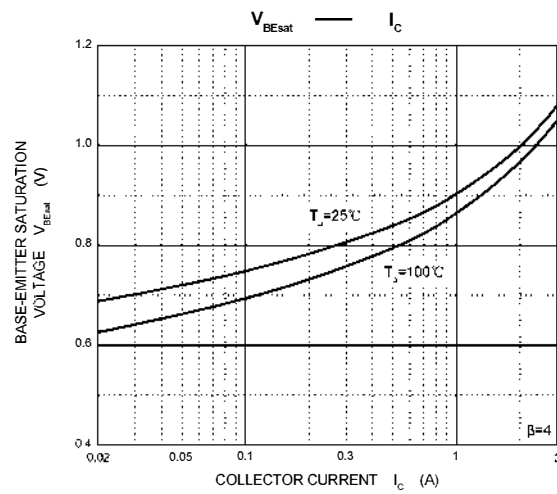
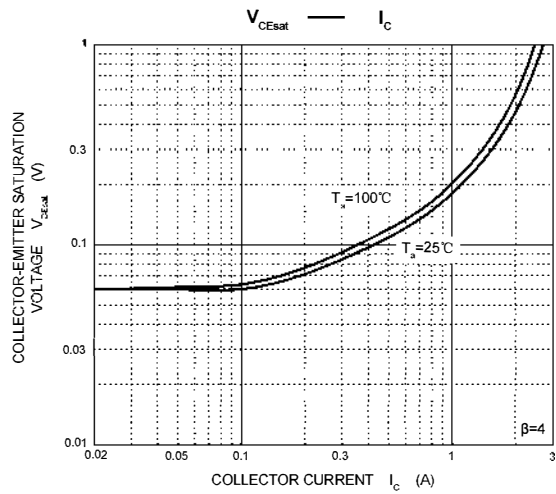
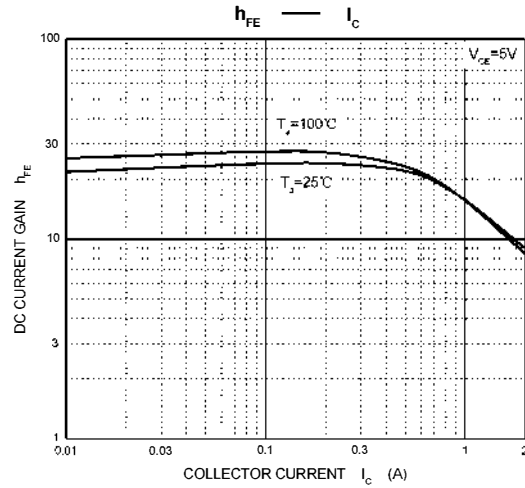
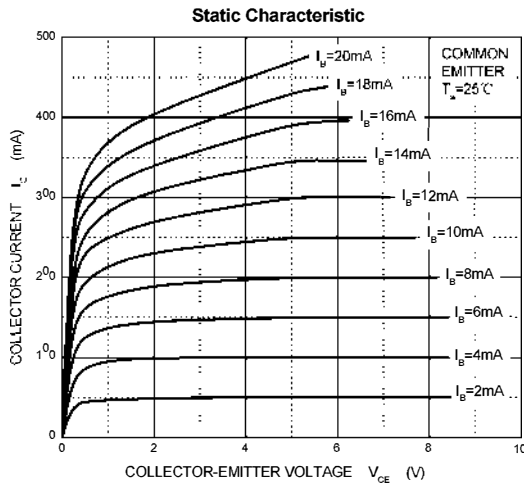

TO-126 Package Outline Dimensions

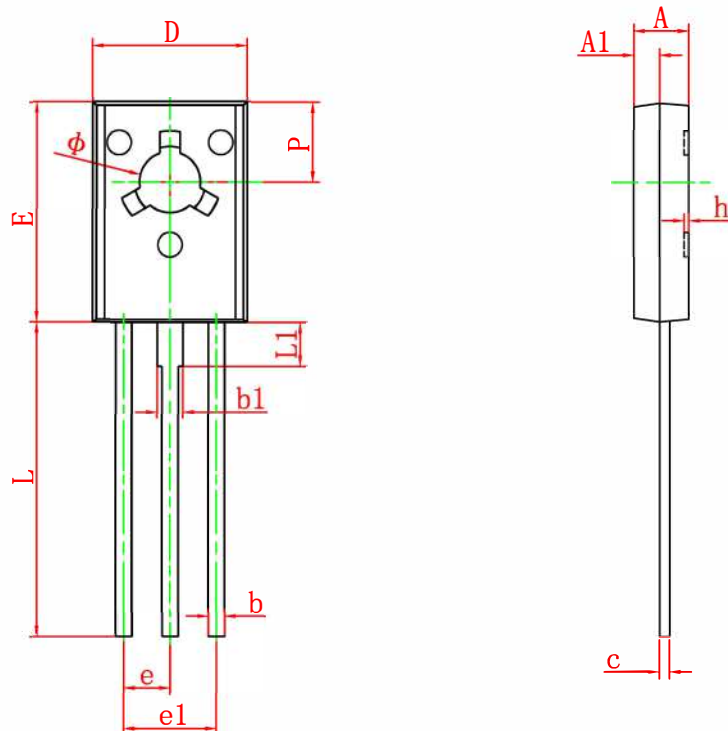

Symbol	Dimensions In Millimeters		Dimensions In Inches	
	Min	Max	Min	Max
A	2.500	2.900	0.098	0.114
A1	1.100	1.500	0.043	0.059
b	0.660	0.860	0.026	0.034
b1	1.170	1.370	0.046	0.054
c	0.450	0.600	0.018	0.024
D	7.400	7.800	0.291	0.307
E	10.600	11.000	0.417	0.433
e	2.290 TYP		0.090 TYP	
e1	4.480	4.680	0.176	0.184
h	0.000	0.300	0.000	0.012
L	15.300	15.700	0.602	0.618
L1	2.100	2.300	0.083	0.091
P	3.900	4.100	0.154	0.161
φ	3.000	3.200	0.118	0.126